

INDIVIDUAL INVENTORY FORM

NHDHR INVENTORY # CEN0054

Name, Location, Ownership

1. Historic name Lake View/Pleasant View Cemetery
2. District or area _____
3. Street and number Main Street
4. City or town Center Harbor
5. County Belknap
6. Current owner Town of Center Harbor

Function or Use

7. Current use(s) Cemetery
8. Historic use(s) Cemetery

Architectural Information

9. Style Vernacular
10. Architect/builder N/A
11. Source N/A
12. Construction date ca. 1809
13. Source Memorials
14. Alterations, with dates _____

15. Moved? no ☒ yes ☐ date: _____

Exterior Features

16. Foundation N/A
17. Cladding N/A
18. Roof material N/A
19. Chimney material N/A
20. Type of roof N/A
21. Chimney location N/A
22. Number of stories N/A
23. Entry location N/A
24. Windows N/A

Replacement? no ☐ yes ☐ date: _____

Site Features

25. Setting Small town or village center
26. Outbuildings N/A
27. Landscape features Fences or fence posts
28. Acreage 0.12



35. Photo #1 Direction: Northeast
36. Date November 24, 2021
37. Reference (file name or frame#): CEN0054-01.jpg

29. Tax map/parcel # Map 102/Lot 077
30. State Plane Feet (NAD83) x 1,038,008
y: 440,129
31. USGS quadrangle and scale Center Harbor 1:24,000
- Form prepared by
32. Name Mae H. Williams
33. Organization _____
34. Date of survey November 24, 2021

INDIVIDUAL INVENTORY FORM

NHDHR INVENTORY # CEN0054

39. LOCATION MAP:

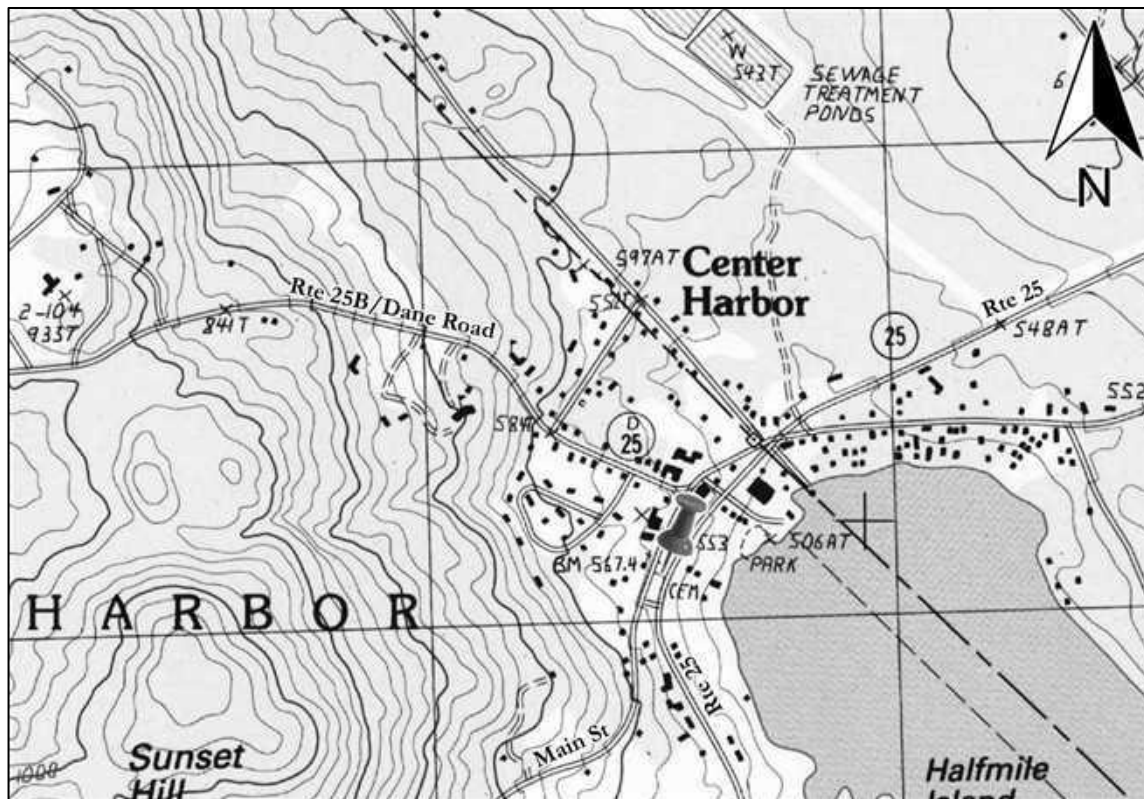

40. PROPERTY MAP:



INDIVIDUAL INVENTORY FORM

NHDHR INVENTORY # CEN0054

41. Historical Background and Role in the Town or City's Development:

The Lake View/Pleasant View Cemetery is located within the center of Center Harbor Village in the Town of Center Harbor. Center Harbor Village, however, was not the original municipal center of the rural community. The first primary village was located on a hilltop to the west, along what is now NH Route 25B/Dane Road. As the pastoral economy of the community shifted to tourism associated with Lake Winnepesaukee, the town center was moved down the hill to the present location at the shore of the lake. It was in the context of this shift that the Lake View cemetery was established.

The Ossipee tribe of the Sokoki nation lived on the northeast shores of Lake Winnepesaukee, and the Penacook confederacy had several villages on the southwest sides of the lake prior to the European settlement of the Lakes Region after the close of the French and Indian Wars.¹ In response to the European exploration of the region, these native people began to withdraw to the north by the mid-1670s.

As early as October of 1763, surveyors Moses Senter (1735-1815) and John Bean (174-1836) are said to have visited the area that would become Center Harbor from Londonderry. "Senter built a log house on the shore [near what is now the Garnet Hill Farm/34 Dewpoint Lane] with plans to return with his family the following summer."² In June of 1764, Senter returned with his wife and son Sam. After the Revolutionary War, Moses Senter constructed a new house on Garnet Hill, on the south side of what is now Old Meredith/Coe Hill Road. Bean also settled in the area in ca. 1764, on land near what is now the Bean Cemetery (262 Bean Road), just over the line in Moultonborough.

In the next few years, the area was surveyed and the Governor of New Hampshire began to grant townships to early settlers. Gov. Benning Wentworth granted the charter for Moultonboro/Moultonborough in 1763,³ the same year that Senter and Bean settled. Soon it was discovered that an oddly-shaped section of land had been overlooked when Moultonboro, Holderness (granted in 1761), and New Salem (1768, now Meredith) had been laid out. This gore or gap became known as Moultonboro Gore and included all of the area that would become New Hampton and Center Harbor. In 1765, the gore was renamed Moultonborough Addition and granted to Col. Jonathan Moulton by Gov. Wentworth.⁴ At this time, however, the southern border of Center Harbor was a straight-line northeast, across the north extent of Meredith to Moultonborough. This meant that most of what is now the primary village in Center Harbor (including the site of the Pleasant View Cemetery) was actually part of New Salem/Meredith until 1873, when the town line was adjusted to put the municipal center of Center Harbor at Center Harbor Village within the boundaries of the town.

Several of the early roads through Center Harbor were laid out in the 1770s, just following this period of early settlement. In 1771, College Road was constructed to link Dartmouth College with Governor Wentworth's home in Wolfeboro.⁵ The road headed west from Moultonborough, by the head of the bay on Winnepesaukee, then west along the approximate route of NH Route 25B to skirt the south side of Squam Lake, then north through Holderness to Ashland. Old Meredith Road (now Main Street/Coe Hill Road) was constructed to connect Meredith Bay and Center Harbor Bay in 1773. Both of these roads served as major coaching lines during this period, and are depicted on the ca. 1784 Holland Map of New Hampshire (**Figure 1**). Center Harbor Neck Road was also constructed by 1784, to connect the Sturtevant farm on the neck with what was then the primary municipal center of the town on the hilltop along what is now 25B (referred to locally as Sunset Hill) and the village along the shore of Lake Winnepesaukee (the current municipal center referred to as Center Harbor village).

The lakeside village began to grow quickly as the result of the convergence of several coaching lines, taking commerce away from the original village on Sunset Hill in the early nineteenth-century. The lakeside village was the half-way station on the once well-known Concord to Freyberg, Maine route, an 84-mile journey that was made in a single day.⁶ The village was also the starting point for excursions by coach through the Crawford and Franconia Notches.⁷ Eventually the municipal

¹ John D. Bardwell and Ronald P. Bergeron, *The Lakes Region of New Hampshire: A Visual History* (Norfolk, VA: The Donning Company, 1989), 29.

² Bardwell, 71. This event is also described in both Centre Harbor Historical Society, *Centre Harbor Historical Society 15th Anniversary 1971-1986* (Laconia, NH: J & J Printing Inc., 1986), 4 and Clarence Johnson "Center Harbor" (*The Granite Monthly*, Vol. XXIII, 1897), 167.

³ Elmer Munson Hunt, *New Hampshire Town Names and Whence They Came* (Peterborough, NH: Noone House, 1970), 65.

⁴ Centre Harbor Historical Society, 10. Moultonborough Addition was incorporated as New Hampton in 1777, and in 1797, Center Harbor split off from New Hampton.

⁵ Bardwell, 62.

⁶ Johnson, 169 and Centre Harbor Historical Society, 25.

⁷ Catherine Hartshorn Campbell, *A Little History of the Squam Lakes* (Holderness, NH: The Squam Lakes Association, 1980), 12.

INDIVIDUAL INVENTORY FORM

NHDHR INVENTORY # CEN0054

center of the town was moved down the hill to the lakeside population and trade center in ca. 1820. After steamboats reached Lake Winnepesaukee in the 1830s, the area became an even more important transportation hub: leading to a host of new hotels, boarding houses, and other ancillary construction to support the thriving industry.

It was during the beginning of this period of rapid growth for Center Harbor Village that the Lake View Cemetery was likely laid out. The oldest interment appears to be that of **Mary Preble Little**, the three-and-a-half-year-old daughter of **Charles Little** (1781-1813)⁸ and **Eliza** (1781-1863)⁹ who died in 1809.¹⁰ Charles Little was likely the same Charles Little who was listed on the 1810 US Federal Census of Center Harbor (then in Strafford County)¹¹ as having a household of eight and who owned a store and tavern with James Little on Sunset Hill along what is now Route 25B.¹² Though it is possible that these people were once buried elsewhere and were moved to the Lake View Cemetery significantly after their deaths, there are no known written records to support this hypothesis. The Lake View Cemetery may have been constructed at the foot of the hill in anticipating of the primary village moving down the hillside to the shore of the Lake or it may have been laid out soon after, with graves moved from private farm cemeteries to the shore at a later date.

During the first half of the nineteenth-century, much of Center Harbor Village was owned by prominent local resident **John Coe** (1797-1861).¹³ Born in Durham, Coe became acquainted with a gentleman who owned an unoccupied store at Center Harbor, went to Portsmouth and bought a stock of general merchandise, and returned to open a general store at Coe House (CEN0012/18 Main Street/102-060-0014) in 1820. He married **Lavinia Senter** in 1823, and returned to Durham for several years. In 1835, he returned to Center Harbor to live in his father-in-law's 1780 homestead/coaching inn (CEN0030/71 Coe Hill Road/103-032). He also purchased his father-in-law's business, the Senter House Hotel (which stood from 1830 to 1888 at the site of the Nichols Memorial Library (CEN0015/35 Plymouth St/102-002)) at around this time. On November 8, 1837, Coe donated a suitable village lot for the construction of a Congregational Church (CEN0003/52 Main Street/102-079) across the street from the Lake View Cemetery.¹⁴ He also served as Center Harbor's postmaster from 1857 to 1861.¹⁵ In addition to running multiple businesses, Coe was a noted abolitionist: his home is said to have been a way station on the Underground Railroad, and he traveled to the south during the Civil War to attempt to free, Richard an enslaved person who belonged to his son.¹⁶

A Congregational Church to serve both Meredith and Center Harbor had been organized in 1815, with services altering between the two communities.¹⁷ The Center Harbor meetings were likely held at the East Meetinghouse, which was constructed on Sunset Hill, below the Morse Cemetery, in 1812.¹⁸ After two decades of sharing a minister, the Center Harbor Congregationalists began fundraising for a new building in August of 1835. After Coe donated the land, the Greek Revival edifice was built by local men during the fall and winter of 1837 for a cost of \$1,700.¹⁹ Interestingly, there is no

⁸ Anonymous, "Find A Grave – Millions of Cemetery Records Online" (www.findagrave.com), Charles Little (1781-1813), buried at Lakeview Cemetery.

⁹ Anonymous, "Find A Grave – Millions of Cemetery Records Online" (www.findagrave.com), Eliza Coffin (1781-1863), buried at South Buxton Cemetery, Buxton, ME with her second husband, David Coffin.

¹⁰ Anonymous, "Find A Grave" (www.findagrave.com), Mary Preble Little (1805-1809), buried at Lakeview Cemetery.

¹¹ United States Federal Census of Center Harbor, Stratford County, New Hampshire, 1810, Household of Charles Little page 4 of 4.

¹² Centre Harbor Historical Society, 14. James Little appears to have been his brother, who died on April 6, 1813, and is buried in Campton. It is interesting that the Little family chose to be buried in the new cemetery adjacent to Winnepesaukee, when they lived more closely to the already established Morse Cemetery (est. ca. 1765).

¹³ Anonymous, "Find A Grave" (www.findagrave.com), John Coe (1797-1861) is buried at the Senter-Coe Cemetery, Center Harbor.

¹⁴ David L. Ruell, "Belknap County Church Survey" (1988), Center Harbor Congregational Church Inventory, 3

¹⁵ Centre Harbor Historical Society, 23.

¹⁶ For additional information on John Coe, please refer to D. Hamilton Hurd, ed. *History of Merrimack and Belknap Counties, New Hampshire* (Philadelphia: J. W. Lewis & Co., 1885), 728ff.

¹⁷ Ruell, Center Harbor Congregational Church Inventory, 3.

¹⁸ Campbell, 11 and Centre Harbor Historical Society, 14. Prior to this date Town and Church meetings had been held in private residences on Sunset Hill.

¹⁹ Ruell, Center Harbor Congregational Church Inventory, 3. The Congregational Church has drastically changed in appearance since it was first constructed. In 1885, the building was remodeled by well-known Concord architectural firm Dow & Wheeler. A high brick basement was constructed beneath the building to create a new vestry and an entrance vestibule was built across the façade. In 1978, vinyl siding and trim were installed over the entire exterior. In 1987-88 a large addition was added by F. G. Antell Construction of Meredith and designed by Wesley Warren.

INDIVIDUAL INVENTORY FORM

NHDHR INVENTORY # CEN0054

known record of the Lake View cemetery ever having been associated with the neighboring Church.²⁰ By the time the Church was constructed, at least fourteen of the people interred at the cemetery had died.

The earliest known documentary evidence of the Lake View Cemetery is the 1860 Belknap County Wall Map images of Center Harbor Village (**Figure 2**).²¹ The map clearly shows the cemetery as a square on the east side of Main Street opposite the Congregational Church. Interestingly, the map also shows the Senter House (then run by Gilman & Huntress) as several commercial blocks owned by John Coe in the small village (J. Coe's house is also identified further southwest along Old Meredith Road/Coe Hill Road in the full town within the larger county map).

Four of the men interred in the Lake View Cemetery are known to have fought in the Civil War:

- Pvt. **Elisha G. Blackey** (1833-63) lived with his parents in Moultonborough in 1850 and worked as a laborer, prior to joining the army.²² He joined Company D of the 4th Regiment of New Hampshire Volunteers on August 6, 1861 in Laconia for a three year-stint and mustered in Manchester under Sgt. G. T. Ingham on September 18, 1861.²³ After he was injured on January 29, 1863, he was discharged from Beaufort, SC and returned to the Lakes Region.²⁴
- Pvt. **George Haddock** (ca. 1823-71) was born in England. By 1860, he was working as a day laborer and living in Sandwich with his wife Sarah and four children.²⁵ He mustered into US Service on September 24, 1862 into Co. K of the 14th Regiment of New Hampshire Volunteers. After he was discharged from service on May 2, 1865, his family resettled in Meredith Village.²⁶ He died in Meredith of pneumonia and was interred at Lake View Cemetery.²⁷
- Pvt. **John Emory Locke** (1840-1900)²⁸ was born in Loudon and enlisted on September 4, 1861. By the time he was hospitalized in February 1862, he was a private in the First Regiment of US Sharpshooters. By 1880, he (37) was working as a house painter and living in Center Harbor village (near the Moultonborough town line) with his wife Susan M. (35), and daughters Alice S. (10) and Grace A. (5).²⁹ By the time of his death from nephritis on October 8, 1900, Locke was serving as Postmaster for Center Harbor.³⁰
- Dr. **William Alphonso Page** (1830-1917) was born in Center Harbor and went to Gilmanton Academy.³¹ He studied medicine at Dartmouth College and practiced in Sandwich between 1855-68, before returning to Center Harbor. During the Civil War, Page served as an assistant surgeon. By 1892, he was living at his father's house on 56 Plymouth Street.³²

Up until the Center Harbor town line was adjusted in 1873, the southwest portion of Main Street (including the Lake View Cemetery) actually in Meredith. From 1873 onward, the Lake View Cemetery has been located within the bounds of Center Harbor.

²⁰ As far as the Congregational Church is aware, the Cemetery has never been associated with the Church (email correspondence with Terry Hughes, Secretary of the Center Harbor Congregational Church, March 2022).

²¹ Further information on the early history of the cemetery may be uncovered with additional deed research at the Belknap County Registry of Deeds, however initial attempts proved unfruitful.

²² In 1850, Elisha lived with his father John (54, laborer), mother Priscilla (41), Loritta L (22), Esther R (19), and Charles A. Catelle (6/12 months) (1850 United States Federal Census of Moultonborough, New Hampshire: Household of John Blackey (dwelling no 13, family no 13)).

²³ New Hampshire Secretary of State, Div. Records Management and Archives, "New Hampshire, Civil War Service and Pension Records, 1861-1866," (www.familysearch.org), Company D of the 4th NH Volunteers.

²⁴ Anonymous, "Find A Grave" (www.findagrave.com), Elisha G. Blackey (1833-1863), buried at Lakeview Cemetery.

²⁵ 1860 United States Federal Census of Sandwich, Household of George Haddock (dwelling no. 468, family no. 468).

²⁶ 1870 United States Federal Census of Meredith, Household of George Haddock (dwelling no. 210, family no. 243).

²⁷ New Hampshire Bureau of Vital Records, "New Hampshire Death Records, 1654-1947" (www.familysearch.org), George Haddock death.

²⁸ Anonymous, "Find A Grave" (www.findagrave.com), John Emory Locke (1841-1900), buried at Lakeview Cemetery.

²⁹ 1880 United States Federal Census of Center Harbor, Household of John Locke (dwelling no. 101, family no. 107).

³⁰ New Hampshire Bureau of Vital Records, "New Hampshire Death Records, 1654-1947", John E. Locke of Center Harbor, NH. Locke became Postmaster on June 12, 1897 and was succeeded by his wife, Susan on October 19, 1900 (Centre Harbor Historical Society, 23).

³¹ Anonymous, "Find A Grave" (www.findagrave.com), William Alphonso Page (1830-1917), buried at Lakeview Cemetery.

³² 2018 Center Harbor Community Planning Survey inventory of the Dr. J. C. Page House (CEN0017/56 Plymouth St/102-055). Page's home was listed as a contributing resource to the National Register Center Harbor Village District in 1983.

INDIVIDUAL INVENTORY FORM

NHDHR INVENTORY # CEN0054

The cemetery was regularly used through the 1920s.³³ After the Civil War, many rural communities began to establish cemetery commissions to oversee public cemetery grounds for their citizens. Prior to this date, many rural families established family plots adjacent to the family farm. Over the subsequent decades many of the rural cemeteries were abandoned, and those interred were exhumed and reinterred at publicly run cemeteries. Although Center Harbor continued to allow the creation and maintenance of private cemeteries, by the 1890s many of the family plots has been abandoned and the bodies reinterred at nearby town-run facilities (for instance, those interred at the Jackson Cemetery on Kline Road were reinterred at the Meredith Cemetery/Plymouth Street Cemetery in Meredith after a plot was purchased by the family in 1890). Center Harbor did not establish a public town cemetery until much later than the surrounding communities, and the Center Harbor Memorial Park was not established until 1970.

By the early twentieth-century, the village of Center Harbor began to change again. In 1919 the second Senter House Hotel (renamed the Colonial Inn in 1904), which stood just north of the cemetery, was destroyed by fire. The property then transferred to the Dane Family, was subdivided, and sold to the town in the early 1950s. By this time, auto-tourism and freight trucking had become more popular, and rail transportation began to lose popularity. The changing reliance on automotive transportation spurred the construction of highways, and in 1953-54 New Hampshire Route 25 was constructed between Lake Winnepesaukee and Center Harbor's Main Street, bypassing the core of the village and sandwiching the Pleasant View Cemetery between a busy motorway and the now quiet Main Street.³⁴

42. Applicable NHDHR Historic Contexts (please list names from appendix C):

Public and Private Cemeteries and Burials

43. Architectural Description and Comparative Evaluation:

The Lake View/Pleasant View Cemetery, established in ca. 1809, is located on a 0.12-acre parcel on the south side of Main Street in the primary village of Center Harbor. The cemetery is located on the side of a hill, overlooking the Center Harbor Bay of Lake Winnepesaukee. The small rectangular cemetery is laid out in five rows and surrounded by fencing with a gate at the center of the west side, opening onto Main Street. NH Route 25 is located just east of the cemetery, and was added in 1953-1954.

The cemetery faces west onto Main Street and is symmetrical in design. Remnants of an historic granite and cast-iron gate are located at the center of the west side of the cemetery and are flanked by a cast-iron fence (**photo 1**). Cast pintels in the quarry-faced granite posts indicate that the entrance once had a cast-iron gate that has been long lost. An historic cast iron fence remains along the west edge of the cemetery and is hung on plug-split granite posts. A modern wooden split-rail fence extends along the other three sides of the cemetery (**photo 2**). The date of the cast-iron fence is unknown, but was likely added to the existing cemetery around the middle of the nineteenth-century as a sign of the growing prosperity of the tourist community.³⁵

The monuments of the Lake View Cemetery offer a wide variety of styles and materials and represent the changing tastes and styles of the nineteenth-century and are laid out in rows that parallel Main Street at the front of the cemetery. The earliest monuments are predominantly slate, with a classic "tombstone" shape, horizontal lettering, and etched urns and willows as is typical of early nineteenth-century tastes (**photos 4 & 5**). Many of the slightly later, mid-nineteenth-century monuments are marble, with curved names surrounding vital information and minimal ornamentation (**photos 6 & 7**). After the Civil War era, the monuments begin to incorporate additional flourishes, reminiscent of the aesthetic movement in art and architecture of that time (**photo 9**).

The area immediately surrounding the cemetery has changed significantly through several phases of growth and demolition since the early nineteenth-century. The cemetery stands opposite the Center Harbor Congregational Church (52 Main Street/CEN0003), which was constructed in 1837 and remodeled in 1885. During the first half of the nineteenth-century,

³³ There are only two internments in the cemetery for people who died more recently: Caroline Porter *Emery* Hill who died in 1949 and is listed on the Moulton Family monument and Helen M. Caverly who died in 1964.

³⁴ David L. Ruell, "National Register of Historic Places Inventory – Nomination Form for the Centre Harbor Village Historic District (1983), 14.

³⁵ The granite fence posts were split using a plug-and feather, a technology for stone-splitting that spread throughout New England after approximately 1830. Earlier posts would have been split using flat wedges.

INDIVIDUAL INVENTORY FORM

NHDHR INVENTORY # CEN0054

the Church was the only structure immediately adjacent to the cemetery. In the 1880s, the area immediately surrounding the cemetery was developed. In 1888, the Senter House Hotel Company purchased the land north of the cemetery, and a large hotel was constructed at the approximate location of the present modern bandstand (constructed in 1998). This 3-story hotel with 91 sleeping rooms, 2 verandas, tennis courts, and a boat house (still surviving), later renamed the Colonial Inn, was destroyed by fire in 1919. The large open parking lot to the south of the Congregational Church, opposite the cemetery, was developed in ca. 1885 when the William Sheafe House was constructed at this location.³⁶

By the 1950s, the remnants of the hotel had been demolished, and the town center embarked on a new building campaign. In 1953-54, NH Route 25 was constructed to the east of the cemetery, bisecting it from the fields that led down to the lake. In the mid-1960s, the area surrounding the former Senter House boathouse was redeveloped as a town beach. In 1965, a motel was constructed on the former Senter House property to the northeast of the cemetery (292-94 Whittier Highway). In ca. 1970, both the United States Post Office and Center Harbor Municipal Building were constructed opposite the bandstand.

The Lake View/Pleasant View Cemetery is a well-preserved example of a rural cemetery established during the early nineteenth-century and is one of several extant cemeteries in Center Harbor. The oldest recorded cemetery in the Town is the **Morse Cemetery** (CEN0040/Garden Wall Lane/211-009), which was constructed in ca. 1765 adjacent to the original Center Harbor Meetinghouse in the first town center on Sunset Hill (now Route 25B/Dane Road). The Morse Cemetery is similar in use as a community burial place with stones laid out in regular rows and reflecting the changing aesthetics of the nineteenth centuries until the most recent burial in 1927. The only other community burial place in Center Harbor is the modern **Center Harbor Memorial Park** (Route 25B/Dane Rd/211-022) which was established in 1970 by the Town. Other family cemeteries were established throughout the town in the nineteenth-century, on the properties of the families they served. Family cemeteries within the town include the ca. 1807-1822 **Sturtevant Cemetery** (CEN0026/Center Harbor Neck Rd/208-009) which was removed to the Bean Cemetery in Moultonborough in ca. 1870; the ca. 1812-present **Canney Hill Cemetery** (CEN0035/College Rd/215-012); the ca. 1813-1965 **Senter-Coe Cemetery** (CEN0031/Coe Hill Rd/103-033); the ca. 1813-1955 **Davis Cemetery** (CEN0082/Waukegan Rd/226-009); the ca. 1825-86 **Greenleaf Cemetery** (CEN0057/McCrillis Hill Rd/222-028); the ca. 1835-1976 **Harrison-Perkins Cemetery** (CEN0090/Waukegan Rd/105-014 & 15); the ca. 1839-2011 **Hawkins Cemetery** (CEN0043/Hawkins Pond Rd/223-028); the ca. 1840-1900 **Cram Cemetery** (CEN0058/7 Piper Hill Rd/226-058); the 1841 **Follet Cemetery** (CEN0038/Follett Rd/216-019) which contains the single grave of D. S. Follet's daughter, Frances Caroline Follett (ca. 1835-1841); the ca. 1860 **Thompson Cemetery** (CEN0064/Route 25B/Dane Rd/215-010) which contains the single grave of Richard Thompson (1787-1860); the bef. 1860-ca. 1890 **Smith Cemetery** (CEN0056/McCrillis Hill Rd/222-031); and the 1980 Rich Cemetery (131 Waukegan Rd/226-008).

44. National or State Register Criteria Statement of Significance:

The Lake View/Pleasant View Cemetery is eligible for the New Hampshire State Register of Historic Places under Criterion A and Criterion C.

Criterion A: The Lake View/Pleasant View Cemetery qualifies for listing to the New Hampshire State Register under Criterion A for community planning and development as an example of a town cemetery whose creation reflects the broad spectrum of the community's history and culture. The early decades of the nineteenth-century were a period of rapid growth for the Town of Center Harbor as the village center shifted from Sunset Hill to the present Center Harbor Village and the economy shifted from subsistence farming to tourism associated with connecting coaching lines to the White Mountains. The formation of the Lake View/Pleasant View village cemetery at this population center provides physical evidence of this economic shift, from early settlement through the evolving sense of community.

Criterion B: The Lake View/Pleasant View Cemetery does not qualify for listing to the New Hampshire State Register under Criterion B. Though associated with persons of local interest, the property lacks strong associations with any persons known to have made highly significant contributions to history.

³⁶ The Sheafe House property was sold to the Congregational Church in 1995, and in 1998 was moved to a temporary site on Bean Road. The house sat on piers for ten years and was demolished in 2009.

INDIVIDUAL INVENTORY FORM

NHDHR INVENTORY # CEN0054

Criterion C: The Lake View/Pleasant View Cemetery is individually eligible for the New Hampshire State Register under Criterion C. The cemetery design reflects the rural cemetery movement aesthetic of funerary design of the nineteenth-century. The overall layout and site topography are indicative of a rural village cemetery from this period with a convenient site near the village center and elevated view site. The layout of the plots, decorative fence and diverse styles of grave markers and headstones and method and material of construction represent many character-defining features of vernacular cemeteries of this period.

The Lake View/Pleasant View Cemetery is not part of any potential historic district due to lack of neighborhood integrity. The immediate area surrounding the cemetery has changed drastically throughout the modern period. When it was constructed, the Cemetery was at the edge of a growing village center, with a grand hotel constructed shortly thereafter to the east and several large ornate dwellings to the northwest and along what is now NH Route 25 south toward Meredith. The adjacent Hotel was destroyed by fire in the early 20th century, the setting of the village core altered significantly by the construction of NH Route 25 in the 1950s, and then many adjacent historic buildings destroyed to make way for modern municipal structures and parking lots in the second-half of the twentieth-century.

45. Period of Significance:

A: ca. 1809-1964

C: ca. 1809

46. Statement of Integrity:

The Lake View/Pleasant View Cemetery retains integrity of location, design, workmanship, feeling and association. The establishment of NH Route 25 between the cemetery and the Lake, and the modern changes to the area immediately surrounding the cemetery have led to a partial loss of integrity of setting. The loss of some of the historic cast-iron fencing and the extreme deterioration of some of the historic monuments has led to some loss of integrity of materials. The overall location, design, materials, feeling and association remain wholly intact, however, and the small cemetery offers a strong memorial to the history of the town's development and the lives of the early villagers.

47. Boundary Discussion:

The boundary of the survey area was limited to the current tax parcel (Map 102-077). The current tax parcel is bounded to the west by Main Street and the opposite Center Harbor Congregational Church (52 Main Street/Map 102-079). To the south is a small undeveloped Town-owned parcel (102-078). To the east the cemetery is bounded by Route 25, and to the north it is bound by the Town Bandstand (102-076). The current parcel is defined by the fence-line of the cemetery, and appears to have remained unchanged since at least 1900.

INDIVIDUAL INVENTORY FORM

NHDHR INVENTORY # CEN0054

48. Bibliography and/or References:

- Anonymous. "Find A Grave – Millions of Cemetery Records Online." Online database (www.findagrave.com).
- Bardwell, John D and Ronald P Bergeron. *The Lakes Region of New Hampshire: A Visual History*. Norfolk, VA: The Donning Company, 1989.
- Belknap County Registry of Deeds.
- Bickford, Gladys S. *The Congregational Church, United Church of Christ, Center Harbor, New Hampshire: 150th Anniversary 1838-1988*. Meredith, NH: Meredith Media Incorporated, 1988. Collection of the Nichols Memorial Library, Center Harbor, NH.
- Campbell, Catherine Hartshorn. *A Little History of the Squam Lakes*. Holderness, NH: Squam Lakes Association, 1980.
- Centre Harbor Historical Society. *Centre Harbor New Hampshire Historical Society 15th Anniversary 1971-1986*. Laconia, NH: J & J Printing Inc., 1986.
- "Lake View Cemetery Inventory." ND [updated 1987].
- Center Harbor, Town of. *Annual Report of the Town of Center Harbor*. Various years.
- Hughes, Terry. Center Harbor Congregational Church Secretary.
- Hunt, Elmer Munson. *New Hampshire Town Names and Whence They Came*. Peterborough, NH: Noone House, 1970.
- Hurd, D. H. & Co. *Town and City Atlas of the State of New Hampshire*. Boston, D. H. Hurd & Co., 1892.
- Hurd, D. Hamilton, ed. *History of Merrimack and Belknap Counties, New Hampshire*. Philadelphia: J. W. Lewis & Co., 1885.
- Johnson, Clarence. "Center Harbor." *The Granite Monthly*, Vol. XXIII, 1897: pages 164-172.
- New Hampshire Bureau of Vital Records. "New Hampshire Death and Disinterment Records, 1654-1949." FamilySearch.org website (www.familysearch.org).
- New Hampshire Secretary of State, Div. of Records and Archives. "New Hampshire Civil War Pension Records 1861-1866." FamilySearch.org website (www.familysearch.org).
- Pocock, Gayle E. "Centre Harbor – An Early History: The Late 1700's to the Early 1900s." May, 1983. Manuscript from the collection of the James E. Nichols Memorial Library, Center Harbor, NH.
- Ruell, David L. "Belknap County Church Survey." New Hampshire Division of Historical Resources Survey Form, 1988. On file with the NH Division of Historical Resources, Concord, NH.
- "National Register of Historic Places Inventory – Nomination Form for the Centre Harbor Village Historic District." 1983. National Park Service website (www.nps.gov).
- United States of America, Bureau of the census. "United States Federal Census." Washington, DC: National Archives and Records Administration, Various Years. FamilySearch.org website (www.familysearch.org).
- Williams, Mae H. "Center Harbor Community Planning Survey." 2018.
- Woodford, E. M. "Map of Belknap County, New Hampshire." 1860. Library of Congress website (www.loc.gov)

Surveyor's Evaluation:

NR listed: individual _____
within district _____

Integrity: yes X
no _____

NR eligible: individual _____
within district X
not eligible _____
more info needed _____

NR Criteria: A X
B _____
C X
D _____
E _____

INDIVIDUAL INVENTORY FORM

NHDHR INVENTORY # CEN0054



Figure 1: Approximate location of Cemetery Site in ca. 1784 showing early Center Harbor Roads

Source: Samuel Holland, "Topographical Map of the State of New Hampshire Surveyed Under the Direction of Samuel Holland" (printed 1784. Library of Congress website www.loc.gov)

INDIVIDUAL INVENTORY FORM

NHDHR INVENTORY # CEN0054

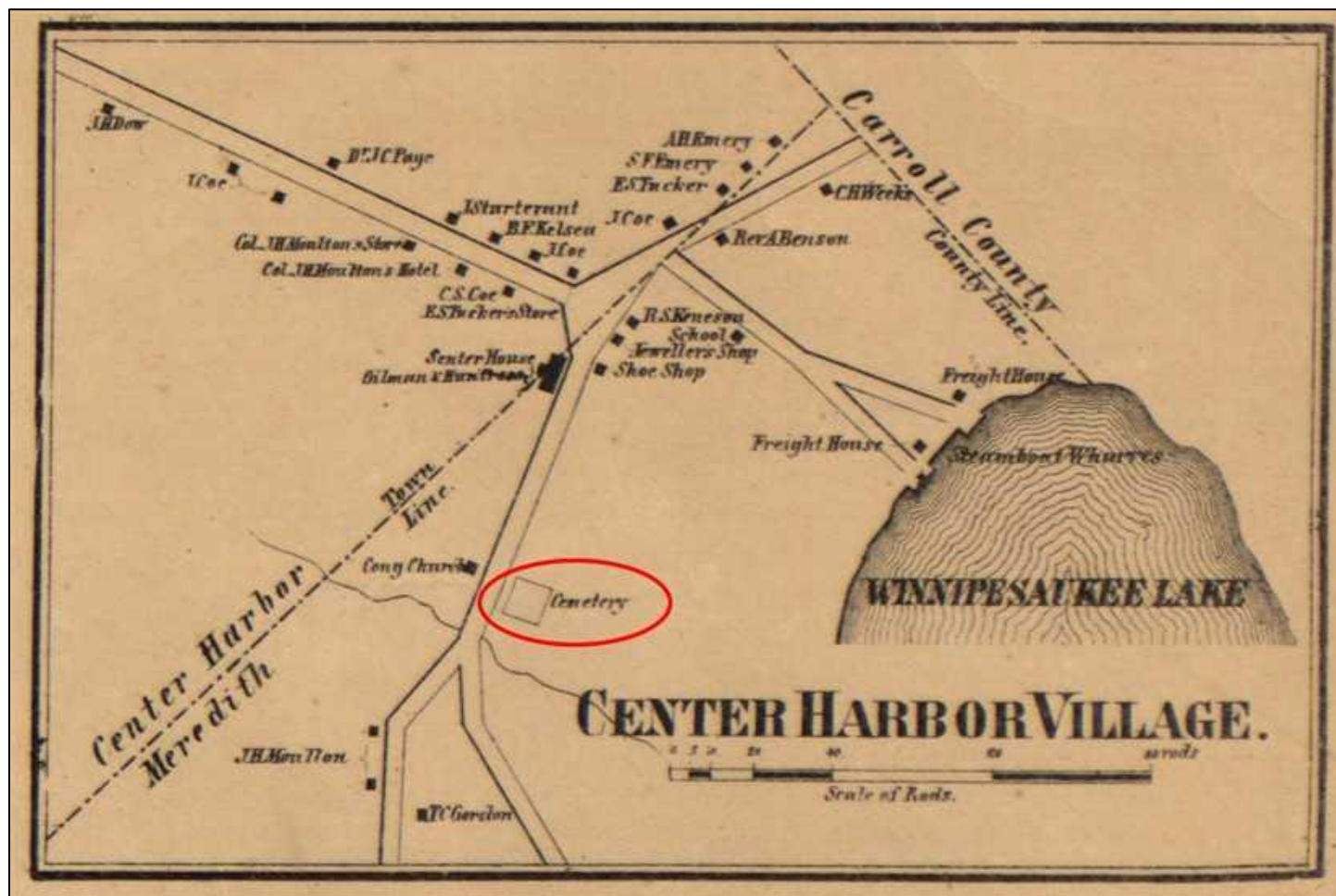

Figure 2: Center Harbor in 1860

Source: E. M. Woodford, "Map of Belknap County, New Hampshire" (1860. Library of Congress website www.loc.gov)



Figure 3: Center Harbor in 1892

Source: D. H. Hurd & Co., Town and City Atlas of the State of New Hampshire (Boston: D. H. Hurd & Co., 1892)

INDIVIDUAL INVENTORY FORM

NHDHR INVENTORY # CEN0054

Date photos taken: November 24, 2021



Photo # 2 Description: Overall view of the cemetery, facing the modern Center Harbor Bandstand to the north
Reference (file name or frame#): CEN0054-02.jpg Direction: Northeast



Photo # 3 Description: Iron and granite fence along entrance to Lake View Cemetery
Reference (file name or frame#): CEN0054-03.jpg Direction: Southwest

INDIVIDUAL INVENTORY FORM

NHDHR INVENTORY # CEN0054

Date photos taken: November 24, 2021



Photo # 4 Description: Headstone for Mary Little, the oldest interment in the Lake View Cemetery
Reference (file name or frame#): CEN0054-04.jpg Direction: East



Photo # 5 Description: 1813 slate headstone of Charles Little with weeping willow and urn
Reference (file name or frame#): CEN0054-05.jpg Direction: East

INDIVIDUAL INVENTORY FORM

NHDHR INVENTORY # CEN0054

Date photos taken: November 24, 2021



Photo # 6 Description: View from Cemetery west to 1835 Congregational Church (remodeled 1885 and 1987/88)
Reference (file name or frame#): CEN0054-06.jpg Direction: Northwest



Photo # 7 Description: 1835 marble headstone of Jonathan Leighton
Reference (file name or frame#): CEN0054-07.jpg

Direction: East

INDIVIDUAL INVENTORY FORM

NHDHR INVENTORY # CEN0054

Date photos taken: November 24, 2021



Photo # 8 Description: 1871 marble memorial for George Haddock
Reference (file name or frame#): CEN0054-08.jpg

Direction: East



Photo # 9 Description: 1876 ornate marble memorial for Arthur Page
Reference (file name or frame#): CEN0054-09.jpg

Direction: East

INDIVIDUAL INVENTORY FORM

NHDHR INVENTORY # CEN0054

Date photos taken: November 24, 2021

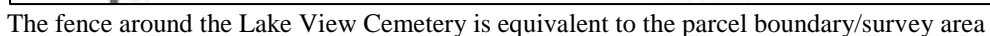

Photo # 10 Description: ca. 1900 marble memorial to John E. Lock, Susan M. *French* Lock, and Grace A. Locke
Reference (file name or frame#): CEN0054-10.jpg Direction: East



Photo # 11 Description: 1917 marble memorial to Dr. William A. Page
Reference (file name or frame#): CEN0054-11.jpg

Direction: East

NHDHR INVENTORY # CEN0054

The fence around the Lake View Cemetery is equivalent to the parcel boundary/survey area

INDIVIDUAL INVENTORY FORM

NHDHR INVENTORY # CEN0054

Appendix A: List of Lake View Cemetery Internments

No.	Name	Birthdate	Death date	Stone No. (see map) -Type Inscription
1	Little, Mary Preble	8 May 1805	January 16, 1809	60 – Headstone (photo 4) "Sacred to the memory of Mary Preble Little, dau of Mr. Charles & Mrs. Eliza Little, who died Jan. 16, 1808 aged 3 years & 8 mos. Keep not of such is the...[below dirt]" 61 – Footstone - "MPL" FindAGrave link: Mary Preble Little 1805-09
2	Little, Charles	1781	March 30, 1813	58 – Headstone (photo 5) "Sacred to the memory of Mr. Charles Little, who died March 30, 1813; in the 32nd year of his age. He bid a solemn adieu to all terrestrial enjoyments, with a joyful hope of a glorious resurrection & blessed immortality beyond the grave..." 59 – Footstone "Mr. Charles Little, 1813" FindAGrave link: Charles Little 1781-1813
3	Clark, Elmira	1804	April 21, 1813	62 - Headstone "In memory of Elmira daughter of Mark L. & Reuben Clark died April 21, 1813, aged 9 years. Morals behold as you pass by as you are now so one was I as I am no you soon must prepare to die and follow me." 63 – Footstone - "EC" FindAGrave link: Elmira Clark 1804-13
4	Emery, Albert Horzo		March 29, 1825	82 – Headstone "Albert Horzo, son of Samuel and Olive Emery died March 29, 1825, age 5 years" 83 – Footstone – "AHE" Not listed on FindAGrave
5	Drake, D.		____ 29, 1826	35 – Headstone "[no name]...29, 1826 age 3 years, 11 days" 36 – Footstone - "DD" FindAGrave link: D Drake ND-1826
6	Emery, Julian		January 29, 1827	84 – Headstone "Julian, daughter of Samuel and Olive Emery died January 29, 1827" 85 – Footstone – "JE" Not listed on FindAGrave
7	Chapin, William B	February 23, 1806	October 8, 1830	10 – Headstone "William B. son of Eber J. & Sarah CHAPIN DIED Oct. 8, 1830 AE 25 His ??? Payer he raised to God and calmly bowed his head in death kind strangers smoothed the thorny rock and angels caught his parting breath." 11 – Footstone FindAGrave link: William B Chapin 1806-30
8	Lang, Harriet		June 10, 1831	44 – Headstone "Mrs. Harriet wife of Thomas Lang [below dirt] died June 10,..." 45 – Footstone – "H. L." FindAGrave link: Harriet Lang ND-1831
9	Emery, Stephen N.	September 1828	November 1831	67 – Monument "Capt. David S. Emery Aug ? 1803 Sept. 1841. RUTH S.....Steven N Emery Sept 1828-Nov. 1831" 79 – Footstone – "SNE" FindAGrave link: Stephen N Emery 1828-31

INDIVIDUAL INVENTORY FORM

NHDHR INVENTORY # CEN0054

No.	Name	Birthdate	Death date	Stone No. (see map) -Type Inscription
10	Moulton, Benning	Mary 20, 1761	December 23, 1834	67 – Moulton Monument "Jona. S. Moulton, Esq. 1785-1855; Deborah, wife 1790-1886; Col. John H. Moulton 1795-1885; Susan S., his wife 1801-1889; <u>Benning Moulton, Esq. 1761-1834</u> ; Sarah, his wife 1756-1826; Smith F. Emery 1836-1920; Susan H. Emery 1835-1921; Walter F. Hill 1864-1919; Caroline P. Hill 1863-1949; John Hale Emery December 1861-April 1862; Alice H. Emery March 1866-September 1887; Capt. David S. Emery August 1803-September 1841; Ruth S., his wife February 1809-April 1878; Stephen N. Emery September 1828-November 1831; David N. Emery November 1838-January 1841" 56 – Footstone – "BM" FindAGrave link: Benning Moulton 1761-1834
11	Leighton, Jonathan	1728	July 28, 1835	24 – Headstone (photo 7) "Jonathan Leighton DIED [below dirt...July 28, 1835]" 25 – Footstone – "JL" FindAGrave link: Jonathan Leighton 1728-1835
12	Moulton, Sarah <i>Leavitt</i>	January 28, 1756	1836	67 – Moulton Monument "...Benning Moulton, Esq. 1761-1834 / Sarah, his wife 1756-1826..." 57 – Footstone – "SM" FindAGrave link: Sarah Moulton 1756-1836
13	Drake, David	April 14, 1768	March 9, 1837	42 – Headstone "David Drake died March 9 1837 AE 68" 43 – Footstone – "DD" FindAGrave link: David Drake 1768-1837
14	Drake, Rhoda J. <i>Perkins</i>	August 13, 1776	November 7, 1837	38 – Headstone "Rhoda consort of David Drake died November 7, 1837, age 59 years" 39 – Footstone – "RJD" FindAGrave link: Rhoda Drake 1776-1837
15	Emery, David N.	November 1838	January 1841	67 – Moulton Monument "...Stephen N. Emery September 1828-November 1831 / David N. Emery November 1838-January 1841" 80 – Footstone – "DNE" FindAGrave link: David N Emery 1838-41
16	Caverly, Emily Jane	June 1840	February 8, 1841	3 – Headstone "Emily Jane, daughter of John T. and Lydia Caverly, Died February 8, 1841 age 8 months" FindAGrave link: Emily Jane Caverly 1840-41
17	Smart, Charles B.	1840	April 8, 1841	23 – Headstone "Charles B., son of Dr. Wm. H. and Nancy Smart died April 8, 1841 age 1 year 10 months" FindAGrave link: Charles B Smart 1840-41
18	Emery, Samuel M.	1795	August 3, 1841	81 – Headstone "Capt. Samuel M. Emery died Aug. 3 1841 AE 45 yrs. 11 mo." [modern stone] FindAGrave link: Samuel M Emery 1795-1841
19	Emery, David S.	August 1803	September 1841	67 – Moulton Monument "...Capt. David S. Emery August 1803-September 1841 / Ruth S., his wife February 1809-April 1878..." 78 – Footstone – "DSE" FindAGrave link: David S Emery 1803-41

INDIVIDUAL INVENTORY FORM

NHDHR INVENTORY # CEN0054

No.	Name	Birthdate	Death date	Stone No. (see map) -Type Inscription
20	Drake, Augusta Ann	May 1837	January 25, 1842	40 – Headstone "Augusta Ann daughter of Simon & Sarah A. Drake died January 25, 1842 AE 4 yrs., 8 mo." 41 – Footstone – "AAD" FindAGrave link: Augusta Ann Drake 1837-42
21	Leighton, James P.	January 21, 1834	February 1, 1842	26 – Headstone "James P. son of Jonathan & Nancy Leighton died Feb. 1, 1842 AE 8 yrs., 11 days" 27 – Footstone – "JPL" FindAGrave link: James P. Leighton 1834-42
22	Benson, Julitta <i>Kingsbury</i>	April 20, 1807	January 11, 1843	32 – Headstone "In Memory of Mrs. Julitta wife of Rev. Almon Benson born Apr. 20, 1807 died Jan 11, 1843 ??????" FindAGrave link: Julitta Benson 1807-43
23	Nichols, Susan <i>Bryant</i>	1796	January 25, 1843	106 – Headstone "Susan, wife of Noah Nichols, died January 25, 1843, age 47 years" 107 – Footstone [no inscription] FindAGrave link: Susan Nichols 1796-1843
24	Haley, Elizabeth <i>Wiggin</i>	1808	August 20, 1845	6 – Headstone "Elizabeth wife of Samuel Haley Died Aug. 30 1845 Age 37 years" (modern stone) 7 – Footstone – "EH" FindAGrave link: Elizabeth Haley 1808-45
25	Drake, Perkins	August 23, 1798	December 10, 1845	37 – Headstone "Perkins Drake died Dec. 10, 1845 AE 47 years 1 month & 17 days" FindAGrave link: Perkins Drake 1798-1845
26	Haley, Samuel	1786	January 25, 1846	4 – Headstone "Samuel Haley died Jan. 25, 1846 AE 60" 5 – Footstone - "SH" FindAGrave link: Samuel Haley 1786-1846
27	Bryant, Lovey <i>Kimball</i>	1802	October 8, 1846	104 – Headstone "Lovey Bryant wife of Richard Bryant DIED Oct. 8, 1846 AE 44" 105 – Footstone – "LB" FindAGrave link: Lovey Bryant 1802-46
28	Gordon, Timothy	1794	November 26, 1846	16 – Headstone (photo 6) "Timothy Gordon DIED Nov. 26, 1846 AE 52 yrs. His Wife Mahala C. DIED Sep. 25, 1866 AE 68 yrs." 17 – Footstone [no inscription] 18 – Footstone [no inscription] FindAGrave link: Timothy Gordon 1794-1846
29	Caverly, John T.	1814	April 16, 1848	1 – Headstone "John T. Caverly DIED Apr 16, 1848 AE 34 Even so that.....??????? Jesus...." 2 – Footstone – "JTC" FindAGrave link: John T Caverly 1814-48
30	Bryant, Joseph	1827	January 27, 1853	101 – Headstone "Joseph Bryant DIED Jan. 27, 1853 AE 26" 102 – Footstone [no inscription] FindAGrave link: Joseph Bryant 1827-53

INDIVIDUAL INVENTORY FORM

NHDHR INVENTORY # CEN0054

No.	Name	Birthdate	Death date	Stone No. (see map) -Type Inscription
31	Moulton, Jonathan Smith	December 14, 1785	November 15, 1855	67 – Moulton Monument "Jona. S. Moulton, Esq. 1785-1855 / Deborah, wife 1790-1886..." 54 – Footstone – "JSM" FindAGrave link: Jonathan Smith Moulton 1785-1855
32	Emery, Olive	1851	1861	48 – Headstone "Sister Olive their Dau 1851-1861" FindAGrave link: Olive Emery 1851-61
33	Drake, Simon	September 23, 1800	May 31, 1861	34 – Headstone "Simon Drake DIED May 31, 1861 AE 60" FindAGrave link: Simon Drake 1800-61
34	Emery, Sarah "Sally" Brown	December 14, 1817	January 14, 1862	47 – Headstone "Mother Sally Brown his wife Dec. 14, 1817 Jan. 14, 1862" FindAGrave link: Sarah Emery 1817-62
35	Emery, John Hale	December 1861	April 1862	67 – Moulton Monument "...John Hale Emery December 1861-April 1862 / Alice H. Emery March 1866-September 1887..." 74 – Footstone – "JHE" FindAGrave link: John Hale Emery 1861-62
36	Blackey, Elisha G.	1833	December 9, 1863	99 – Headstone "Elisha G. Blackey soldier in Co. D 4th Reg. NHV Died Dec. 9, 1863 AE. 30" 100 – Footstone – "EGP" FindAGrave link: Elisha G Blackey 1833-63
37	Paine, Nathaniel	1777	August 20, 1864	95 – Headstone "Nath'l Paine died August 20, 1864 age 87 years" 96 – Footstone – "NP" FindAGrave link: Nathaniel Paine 1777-1864
38	Stevens, John F.	1819	November 16, 1865	64 – Headstone - "Father" 65 – Stevens Monument – Side 1: "Mr. John F. Stevens died November 16, 1865 age 46" Side 2: "Mrs. Mary A. Stevens died May 26, 1836 age 66 Mrs. J. Emma Horn died May 16, 1886 age 37" FindAGrave link: John F Stevens 1819-65
39	Worthen, Charles F.		April 4, 1866	93 – Headstone "Charles F., son of S. and M. J. Worthen, died April 4, 1866, age 1 year" 94 – Footstone – "CFW" FindAGrave link: Charles F Worthen ND-1866
40	Gordon, Mahala Chase <i>Morrison</i>	April 11, 1798	September 25, 1866	16 – Headstone (photo 6) "Timothy Gordon DIED Nov. 26, 1846 AE 52 yrs. His Wife Mahala C. DIED Sep. 25, 1866/ AE 68 yrs." FindAGrave link: Mahala Chase Gordon 1798-1866
41	Haddock, George	1823	April 9, 1871	92 – Headstone (photo 8) "Geo. Haddock Co. K 14th Regt. N. H. V. DIED Apr. 9, 1871" FindAGrave link: George H Haddock 1823-71
42	Page, Arthur C.	1846	January 4, 1876	49 – Headstone - "Arthur C. Page, Husband" (photo 9) 50 – Footstone – [no inscription] FindAGrave link: Arthur C Page 1846-76
43	Emery, Alpheus C.	November 26, 1815	September 20, 1876	46 – Headstone "Alpheus C. Emery, born November 26, 1815 died September 20, 1876" FindAGrave link: Alpheus C Emery 1815-76

INDIVIDUAL INVENTORY FORM

NHDHR INVENTORY # CEN0054

No.	Name	Birthdate	Death date	Stone No. (see map) -Type Inscription
44	Emery, Ruth S. <i>Norris</i>	February 1809	April 1878	67 – Moulton Monument "...Capt. David S. Emery August 1803-September 1841 / Ruth S., his wife February 1809-April 1878..." 77 – Footstone – "RSE" FindAGrave link: Ruth S Emery 1809-78
45	Page, John Cummings	May 4, 1804	November 4, 1879	51 – Headstone "Rev. John C. Page M.D. born May 4, 1804 died November 4, 1879 Mary A. Eastman, wife born May 21, 1807 died May 27, 1892" FindAGrave link: John Cummings Page 1804-79
46	Blackey, John W.	1804	May 24, 1883	108 – Headstone "Father, John W. Blackey died May 24, 1883 age 80 years Mother, Betsy E., wife of John Blackey died October 11, 1891, age 83 years" 109 – Footstone [no inscription] FindAGrave link: John W. Blackey 1804-83
47	Benson, Almon	June 3, 1810	September 13, 1884	30 – Headstone "Rev. Almon Benson Died Sept. 13, 1884. A.E. 74 yrs. Ordained pastor of the ????? Church of Centre Harbor Dec. 23, 1840: Dismissed Nov. 10, 1863." 31 – Footstone – "PB" [sic!] FindAGrave link: Almon Benson 1810-84
48	Moulton, John Hale	June 24, 1795	June 3, 1885	67 – Moulton Monument "...Col. John H. Moulton 1795-1885 / Susan S., his wife 1801-1889..." 53 – Footstone – "JHM" FindAGrave link: John Hale Moulton 1795-1885
49	Moulton, Deborah <i>Neal</i>	1790	1886	67 – Moulton Monument "Jona. S. Moulton, Esq. 1785-1855 / Deborah, wife 1790-1886..." 55 – Footstone – "DM" FindAGrave link: Deborah Moulton 1790-1886
50	Horn, Julian Emma <i>Stevens</i>	1849	May 16, 1886	65 – Stevens Monument "John F. Stevens died November 16, 1865 age 46 Mrs. Mary A. Stevens died May 26, 1836 age 66 Mrs. J. Emma Horn died May 16, 1886 age 37" FindAGrave link: Julia Emma Horn 1849-86
51	Stevens, Mary Ann <i>Kimball</i>	1820	May 26, 1886	65 – Stevens Monument "John F. Stevens died November 16, 1865 age 46 Mrs. Mary A. Stevens died May 26, 1836 age 66 Mrs. J. Emma Horn died May 16, 1886 age 37" 66 – Headstone – "Mother" FindAGrave link: Mary Ann Stevens 1820-86
52	Emery, Alice Huntington	March 1866	September 17, 1887	67 – Moulton Monument "...John Hale Emery December 1861-April 1862 / Alice H. Emery March 1866-September 1887..." 73 – Footstone – "AHE" FindAGrave link: Alice Huntington Emery 1866-87
53	Bryant, Sarah <i>Kimball</i>	April 14, 1800	October 20, 1888	103 – Headstone "Sarah wife of Richard Bryant died Oct. 20, 1888 AE 88 yrs. 6 mo. 6 dys" FindAGrave link: Sarah Bryant 1800-88
54	Page, Sarah L. <i>Emery</i>	June 16, 1832	February 13, 1889	70 – Headstone "Sarah L., wife of Dr. Wm. A. Page born June 16, 1832, died February 13, 1889" FindAGrave link: Sarah L Page 1832-89

INDIVIDUAL INVENTORY FORM

NHDHR INVENTORY # CEN0054

No.	Name	Birthdate	Death date	Stone No. (see map) -Type Inscription
55	Weeks, Charles Henry	April 14, 1823	February 14, 1889	91 – Headstone "Charles H. Weeks born April 14, 1823, died February 14, 1889; Polly W. Weeks born July 20, 1827 died June 30, 1910" FindAGrave link: Charles Henry Weeks 1823-89
56	Moulton, Susan Sargent <i>Porter</i>	1801	September 21, 1889	67 – Moulton Monument "...Col. John H. Moulton 1795-1885 / Susan S., his wife 1801-1889..." 52 – Footstone – "SSM" FindAGrave link: Susan Sargent Moulton 1801-89
57	Blackey, Betsy E. <i>Bryant</i>	1808	October 11, 1891	108 – Headstone "Father, John W. Blackey died May 24, 1883 age 80 years Mother, Betsy E., wife of John Blackey died October 11, 1891, age 83 years" 110 – Footstone [no inscription] FindAGrave link: Betsy E Blackey 1808-91
58	Page, Mary Ann <i>Eastman</i>	May 21, 1807	May 27, 1892	51 Headstone "Rev. John C. Page M.D. born May 4, 1804 died November 4, 1879; Mary A. Eastman, wife born May 21, 1807 died May 27, 1892" FindAGrave link: Mary Ann Page 1807-92
59	Gordon, Harriet S. <i>Burleigh</i>	November 1, 1829	August 6, 1892	19 – Headstone (photo 6) "Harriet S. wife of Timothy C. Gordon DIED Aug. 6, 1892 AE 62" (wife inscribed on back) 20 – Footstone [no inscription] FindAGrave link: Harriet S Gordon 1829-92
60	Staples, Sarah Annie E. <i>Copp</i>	January 7, 1830	February 13, 1895	[No stone: Information on Sarah only through FindAGrave.com?] FindAGrave link: Sarah Annie E Staples 1830-95
61	Benson, Rhoda Amanda <i>Royce</i>	1818	February 20, 1896	28 – Headstone "Rhoda A. / wife of / Rev. Almon Benson / DIED / Feb. 20, 1896 / AE 78 yrs. / He giveth his beloved sleep." 29 – Footstone [no inscription] FindAGrave link: Rhoda Amanda Benson 1818-96
62	Gordon, Timothy C.	June 23, 1830	September 29, 1896	21 – Headstone (photo 6) "Timothy C. Gordon DIED Sept. 29, 1896 AE 66" 22 – Footstone [no inscription] FindAGrave link: Timothy C Gordon 1830-96
63	Locke, Grace A.	September 19, 1875	January 8, 1900	15 – Headstone (photo 10) LOCKE John E. Locke 1840-1900; Susan M. French His Wife 1843-1904; Grace A. Their Daughter 1875-1900" FindAGrave link: Grace A Locke 1875-1900
64	Benson, Julitta Kingsbury	August 26, 1846	June 25, 1900	13 – Headstone "Julitta K. Benson died June 25, 1900 AE. 53 yrs. 10 mos." FindAGrave link: Julitta Kingsbury Benson 1846-1900
65	Locke, John Emory	December 9, 1840	October 8, 1900	15 – Headstone (photo 10) LOCKE John E. Locke 1840-1900; Susan M. French His Wife 1843-1904; Grace A. Their Daughter 1875-1900" FindAGrave link: John Emory Locke 1840-1900
66	Locke, Susan M. <i>French</i>	December 1, 1843	January 4, 1904	15 – Headstone (photo 10) LOCKE John E. Locke 1840-1900; Susan M. French His Wife 1843-1904; Grace A. Their Daughter 1875-1900" FindAGrave link: Susan M Lock 1843-1904

INDIVIDUAL INVENTORY FORM

NHDHR INVENTORY # CEN0054

No.	Name	Birthdate	Death date	Stone No. (see map) -Type Inscription
67	Page, Maria A. <i>Mooney</i>	November 1, 1836	January 9, 1904	68 – Headstone "Maria M., wife of Dr. Wm. A. Page born November 1, 1836 died January 9, 1904" FindAGrave link: Maria A Page 1836-1904
68	Weeks, Polly <i>Wadleigh</i>	July 20, 1827	June 30, 1910	91 – Headstone "Charles H. Weeks born April 14, 1823, died February 14, 1889; Polly W. Weeks born July 20, 1827 died June 30, 1910" FindAGrave link: Polly Weeks 1827-1910
69	Drake, Sarah A. <i>Moulton</i>	April 8, 1812	October 9, 1912	33 - Headstone "Mrs. Sarah A. Drake April 8, 1812 Oct. 9, 1912" FindAGrave link: Sarah A. Drake 1812-1912
70	Jackson, William C.	1843	April 15, 1916	14 – Headstone "William G. Jackson 1843-1916; Wife, Elizabeth R. Benson 1848-1924" FindAGrave link: William C. Jackson 1843-1916
71	Page, William Alphonso	April 12, 1830	February 10, 1917	69 – Headstone (photo 11) "Dr. William A. Page born April 12, 1830, died February 10, 1917" FindAGrave link: William Alphonso Page 1830-1917
72	Hill, Walter F.	October 13, 1864	May 19, 1919	67 – Moulton Monument "...Walter F. Hill 1864-1919 / Caroline P. Hill 1863-1949 ..." 71 – Footstone – "WFH" FindAGrave link: Walter F. Hill 1864-1919
73	Emery, Smith F.	April 1, 1836	January 16, 1920	67 – Moulton Monument "...Smith F. Emery 1836-1920; Susan H. Emery 1835- 1921..." 76- Footstone – "SFE" FindAGrave link: Smith F. Emery 1836-1920
74	Emery, Susan Huntington Porter <i>Moulton</i>	December 14, 1835	December 14, 1921	67 – Moulton Monument "...Smith F. Emery 1836-1920, Susan H. Emery 1835-1921 ..." 75 – Footstone – "SHE" FindAGrave link: Susan Huntington Porter Emery 1835-1921
75	Jackson, Elizabeth R. <i>Benson</i>	1848	1924	14 – Headstone "William G. Jackson 1843-1916; Wife, Elizabeth R. Benson 1848-1924" FindAGrave link: Elizabeth R. Jackson 1848-1924
76	Hill, Caroline Porter <i>Emery</i>	1863	1949	67 – Moulton Monument "...Walter F. Hill 1864-1919 / Caroline P. Hill 1863-1949 ..." FindAGrave link: Caroline Porter Hill 1863-1949
77	Caverly, Helen M.	1884	1964	12- Headstone - "Helen M. Caverly / 1884-1964" FindAGrave link: Helen M. Caverly 1884-1964
78	H., C. A.			72 – Footstone - "CAH" [possibly a member of the Moulton family?]
79	E., S. M.			97 – Headstone - "SME"
80	[Unknown]			8 – Fieldstone [no inscription] 9 – Fieldstone [no inscription]
81	[Unknown]			86 - Fieldstone [no inscription]
82	[Unknown]			87 - Fieldstone [no inscription] 88 – Fieldstone [no inscription]

INDIVIDUAL INVENTORY FORM

NHDHR INVENTORY # CEN0054

No.	Name	Birthdate	Death date	Stone No. (see map) -Type Inscription
83	[Unknown]			90 - Fieldstone [no inscription] 89 – Fieldstone [no inscription]
84	[Unknown]			98 - Fieldstone [no inscription]